

Single nozzles DHC and nozzles for multicavity moulds DH

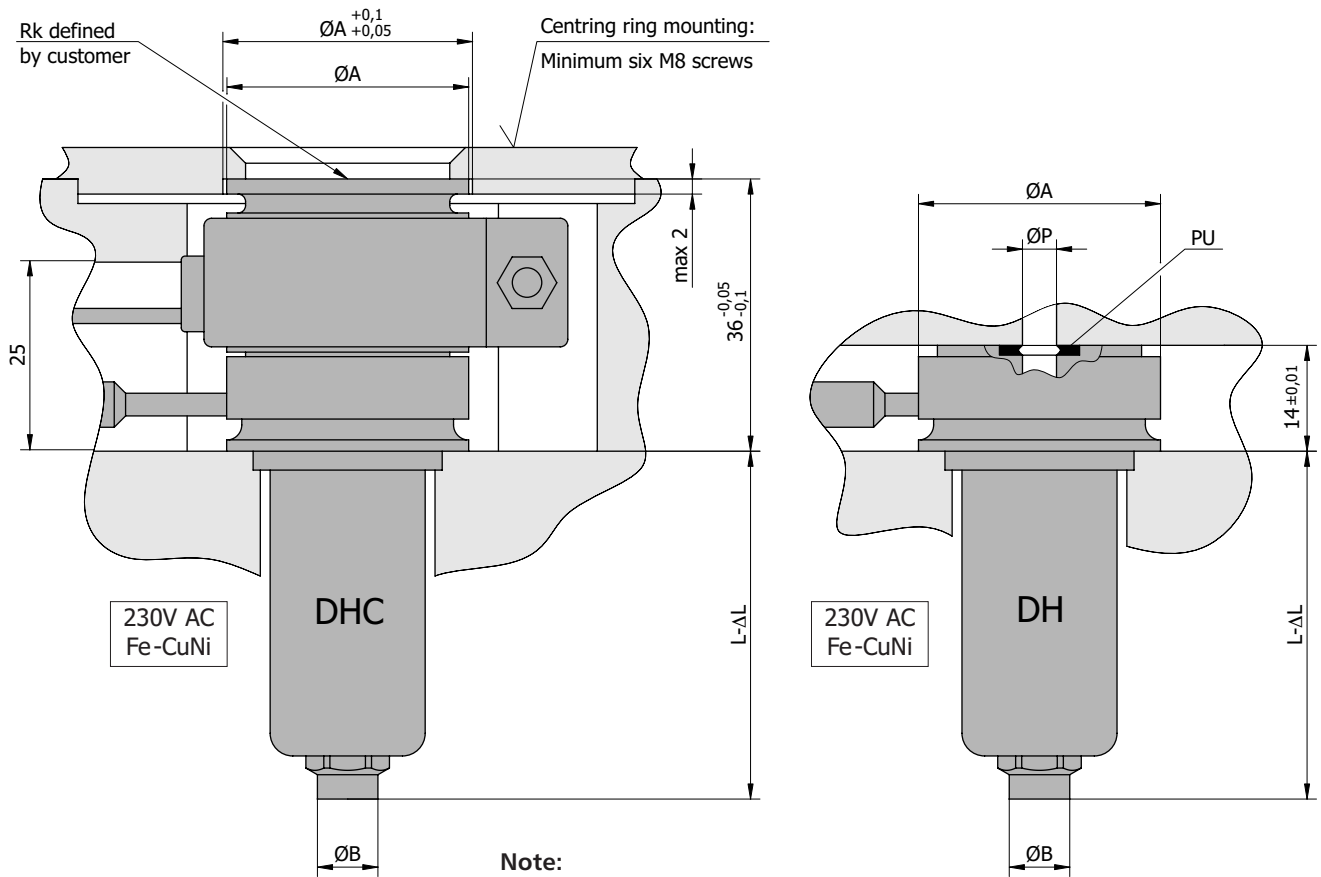

Note:
 • $\Delta L \cong 0,0025 L$ – Dimension including nozzle thermal expansion.

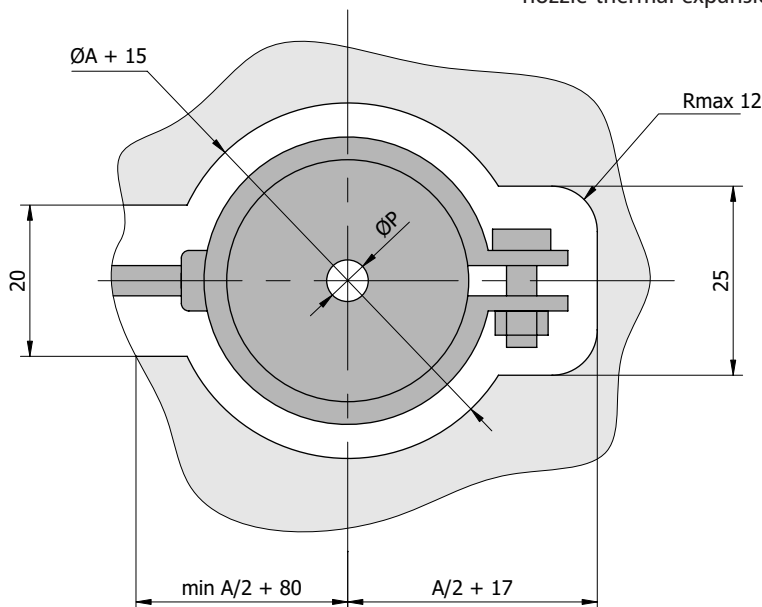

- KS** – standard tip made of beryllium bronze. Processing all non-reinforced plastics and 280°C. plastics without anti-burn additives. Processing temperature up to 280°C.
- KT** – special tip made of tungsten alloys. Processing of all plastics, including reinforced ones and plastics with anti-burn additives. Processing temperature up to 360°C.

DHC and DH nozzles are in the standard version equipped with a spiral heater GS. Optionally they can be equipped with a tubular heater GT which is recommended for processing thermally sensitive plastics and technical plastics (page 32).

Single nozzles DHC and nozzles for multicavity moulds DH

Nozzle type	Ø A	Ø B	Ø C	Ø F	G	H _{max}	Ø P	W	Ø X
DHC	1	28	6	19	22	1,8	12	6	0,8 ÷ 1,5
	2	32	8	22	25	2	14	6,5	0,8 ÷ 2,0
DH	3	36	10	25	28	2,2	16	7	1,0 ÷ 2,5
	4	40	12	28	31	2,4	19	7,5	1,0 ÷ 3,0
	5	44	14	31	34	2,6	22	8	1,2 ÷ 3,5
	6	48	16	34	37	2,8	25	8,5	1,2 ÷ 4,0

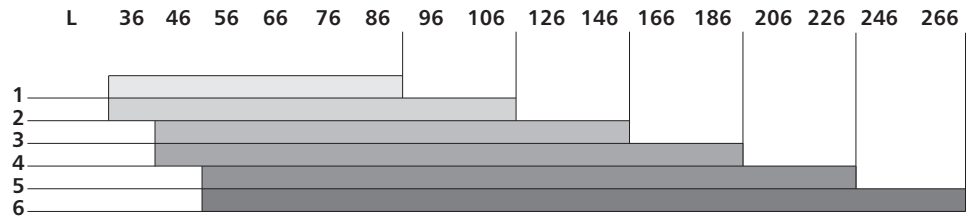

Nozzle seat for DHC and DH

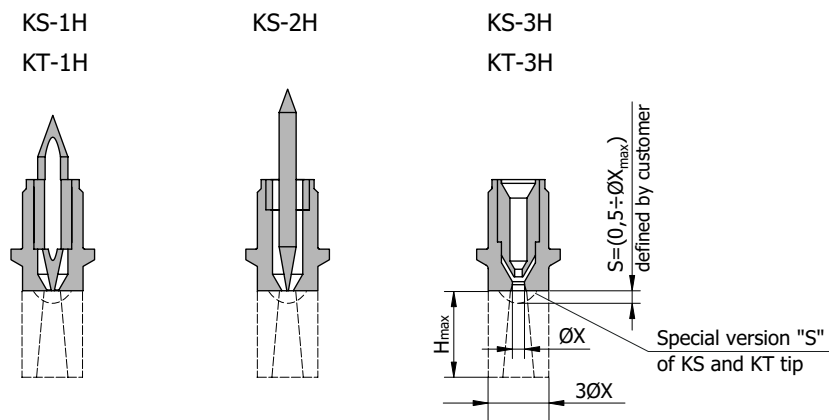
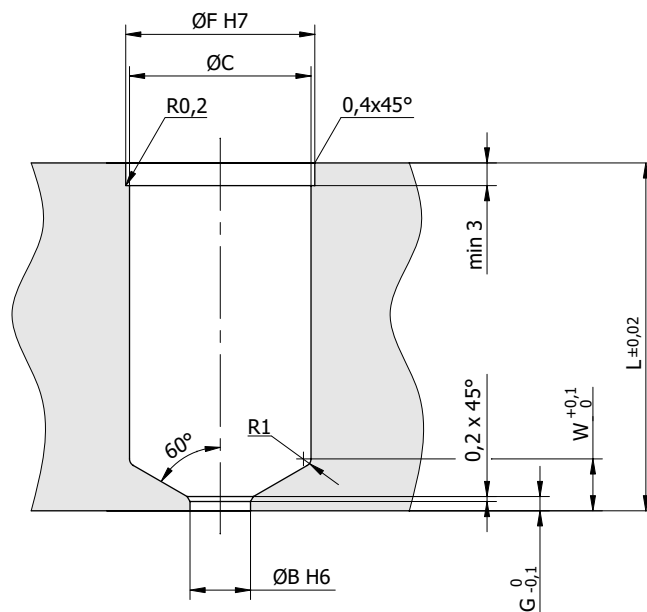

How to order:

Nozzle type / Nozzle length / Tip type / Gate diameter / Rk for single nozzles

Example: DHC-2 / L=76 / KT-1H / ØX=1,2 / Rk=15