

4 cavity manifold type RP

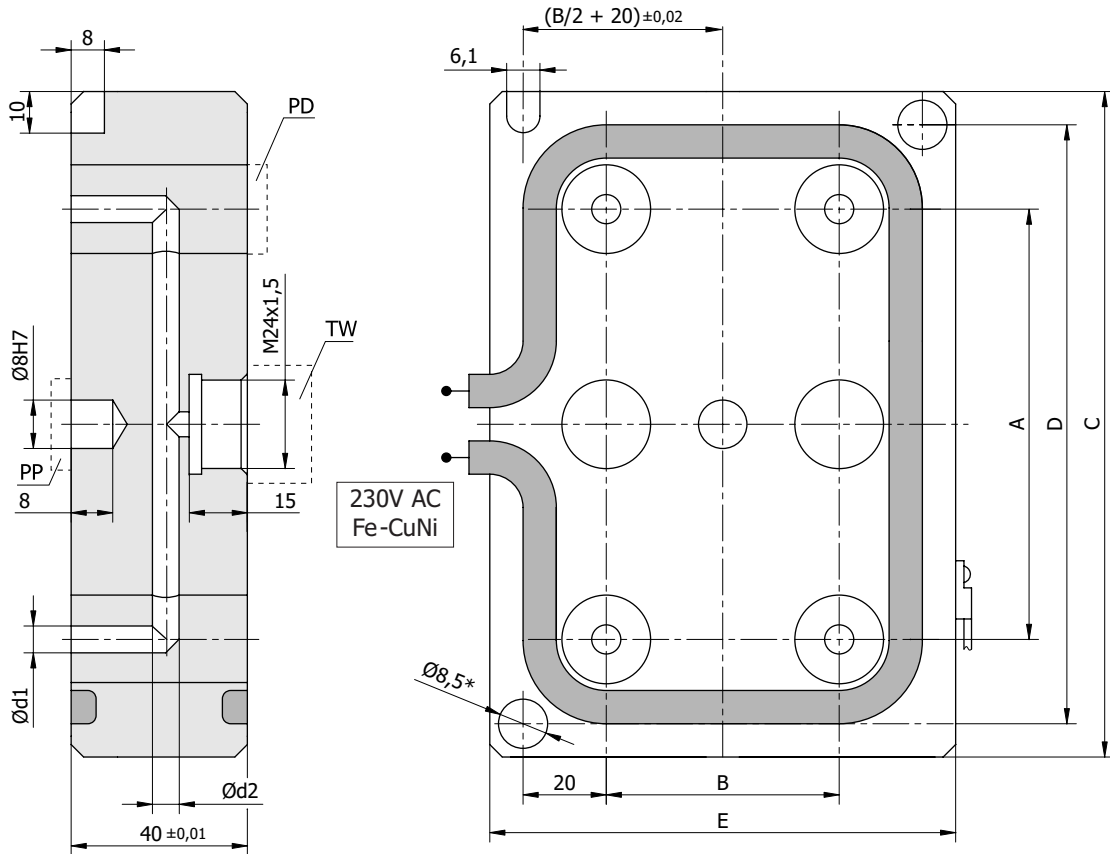

manifold type	A		B	C	D	E	Ø d1	Ø d2	P per zone	number of heating zones
	min	max								
RP - 1	50	100	60	156	140	116	4	6 8 10 12 14	2000	1
RP - 2	100	150	60	206	190	116	5,5		2500	1
RP - 3	50	100	70	156	140	126	7		2000	1
RP - 4	100	150	70	206	190	126	9		2500	1
RP - 5	50	100	80	156	140	136	11		2500	1
RP - 6	100	150	80	206	190	136	13		2800	1

Note:

- Dimension Ø8,5* changes into M10 thread which facilitates removing manifold from the injection mould.
- Diameters of channels inside the manifold Ød1 and Ød2 are defined for each nozzle type.
- Spacing washers PD have standard height 12. The height of bearing washer PP is defined for each nozzle type.

How to order:

Manifold type / Injection points spacing / Injection bushing dimensions (see p. 31)

Example: RP-1 / A=75 / TW